

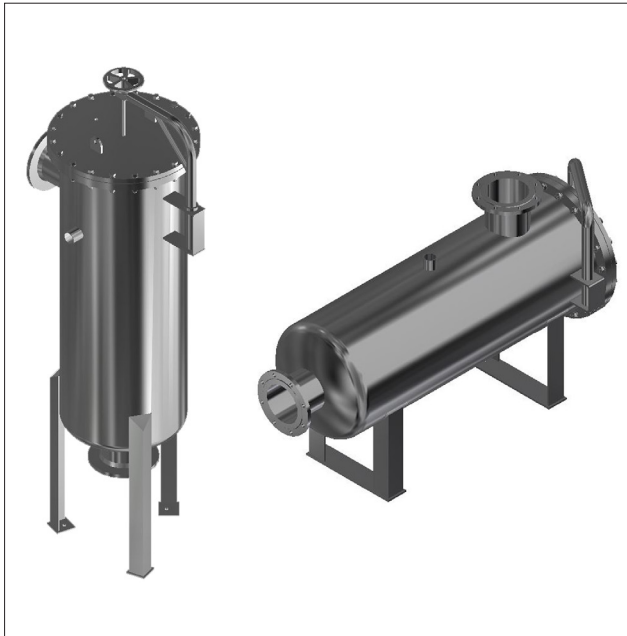

# HPM Filter Housings

Filter housing for Parmax and Parmax-R



Parker domnick hunter offer a range of housings for Parmax and Parmax-R large diameter cartridges. The range consists of single, 3 and 5 round housings.

The range is available in both horizontal and vertical configurations. A horizontal arrangement makes change-outs easier, whereas a vertical set up can be advantageous where space is limited. Parker's range of HPM vessels offer significant footprint and cost reduction possibilities in comparison to conventionally sized cartridges.

The vessels are designed for high flow rates and large volume operations where the large diameter and increased surface area of the elements offer significant advantages in decreasing the downtime associated with change-outs when compared to standard 2.5" diameter cartridges.

Features	Benefits
Designed for use with large diameter cartridges.	Smaller number of cartridges facilitates quick and simple change-out.
Horizontal and vertical orientation options.	Installation optimisation to facilitate floor space planning.
Reduced footprint requirement and high flow operation.	Reduced capital outlay and lower operating costs.

- ✓ Completion fluids
- ✓ Pre-filtration for desalination
- ✓ API's and solvents

APPLICATIONS

## Specifications

### Materials of Construction

Type:	SS 316 Ti
Seal material:	EPDM FDA
Surface finish Internal and external:	Pickled and passivated
Welding:	All welds are full penetration, crevice and undercut free.

### Certification:

Supplied as standard with vessel inspection certificate

### Material Test Certification:

EN10204 3.1 supplied upon request.  
only available at time of order.

### Directives:

Housings designed in accordance with the European Council Pressure Equipment Directive (PED).

### Fluid Group:

Group 2 (non hazardous) liquids.

### Design Basis:

AD-2000

### Maximum Recommended Operating Conditions:

Temperature:  
-10 / 90°C (14 - 194°F)

### Maximum Allowable Pressure:

-1 / 10 bar (-14.5 / 145 psi).

### Volume:

Volume (Litres)	20"	40"	60"
HMPCE01	27L	46L	64L
HPMCE03	-	450L	590L
HMPCE05	-	450L	590L



# HPM Filter Housings

Filter housing for Parmax and Parmax-R

## Specifications

### Physical Characteristics:

Dimensions are approximate only, based on illustration shown with flanged fittings, BSP / NPT vent and drains available, supplied without plugs. For accurate dimensions, please contact Parker domnick hunter.

## Dimensions

3 and 5 Round Housings - Vertical Dimensions (mm)

		3 Round Housings		5 Round Housings	
		40" Height	60" Height	40" Height	60" Height
DN150	DIM 'A'	1850	2360	1850	2360
	DIM 'B'	450	450	450	450
	DIM 'C'	425	425	485	485
	DIM 'D'	315	315	340	340
	DIM 'E'	450	450	610	610
DN200	DIM 'A'	1850	2360	1850	2360
	DIM 'B'	560	560	560	560
	DIM 'C'	425	425	485	485
	DIM 'D'	315	315	340	340
	DIM 'E'	450	450	610	610
DN250	DIM 'A'	1850	2360	1850	2360
	DIM 'B'	700	700	700	700
	DIM 'C'	425	425	485	485
	DIM 'D'	315	315	340	340
	DIM 'E'	450	450	610	610

3 and 5 Round Housings - Horizontal Dimensions (mm)

		3 Round Housings		5 Round Housings	
		40" Height	60" Height	40" Height	60" Height
DN150	DIM 'A'	1850	2360	1850	2360
	DIM 'B'	450	450	450	450
	DIM 'C'	315	315	340	340
	DIM 'D'	425	425	485	485
	DIM 'E'	450	450	610	610
DN200	DIM 'A'	1850	2360	1850	2360
	DIM 'B'	860	1100	860	1100
	DIM 'C'	315	315	340	340
	DIM 'D'	425	425	485	485
	DIM 'E'	450	450	610	610
DN250	DIM 'A'	1850	2360	1850	2360
	DIM 'B'	860	1100	860	1100
	DIM 'C'	315	315	340	340
	DIM 'D'	425	425	485	485
	DIM 'E'	450	450	610	610



# HPM Filter Housings

Filter housing for Parmax and Parmax-R

## Specifications

Single Housing - Vertical

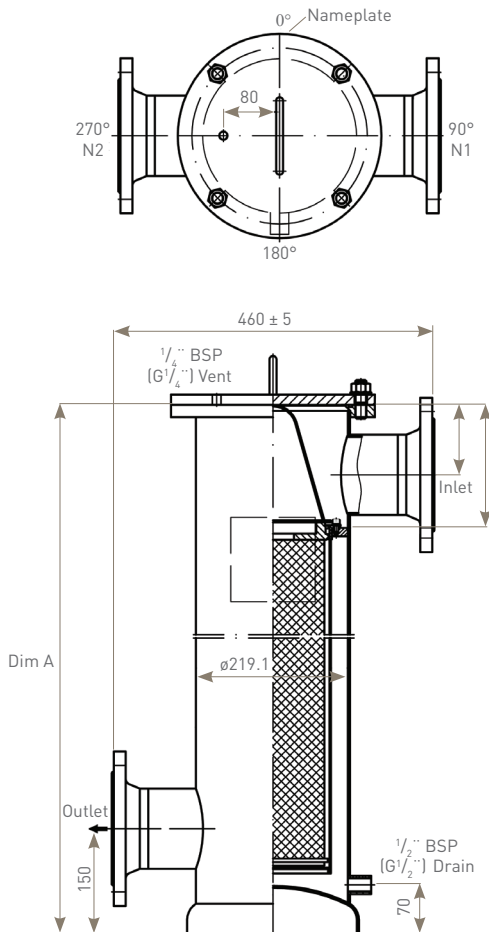

3 & 5 Round Housing - Vertical

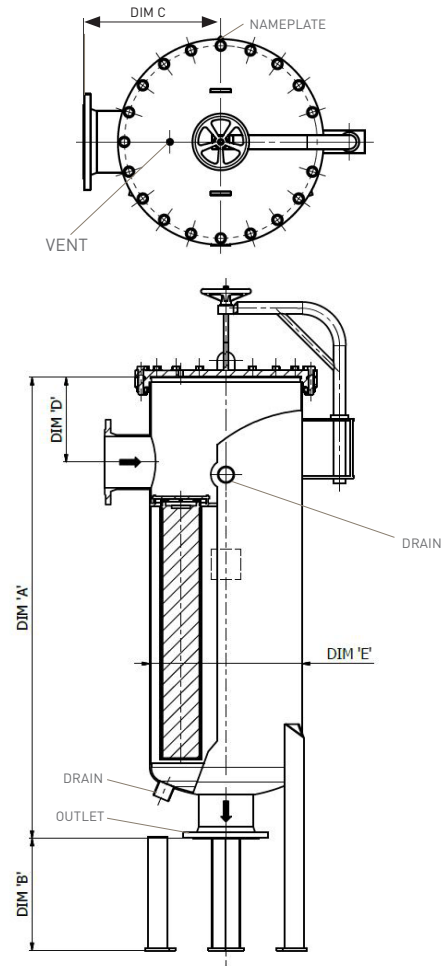

3 & 5 Round Housing - Horizontal

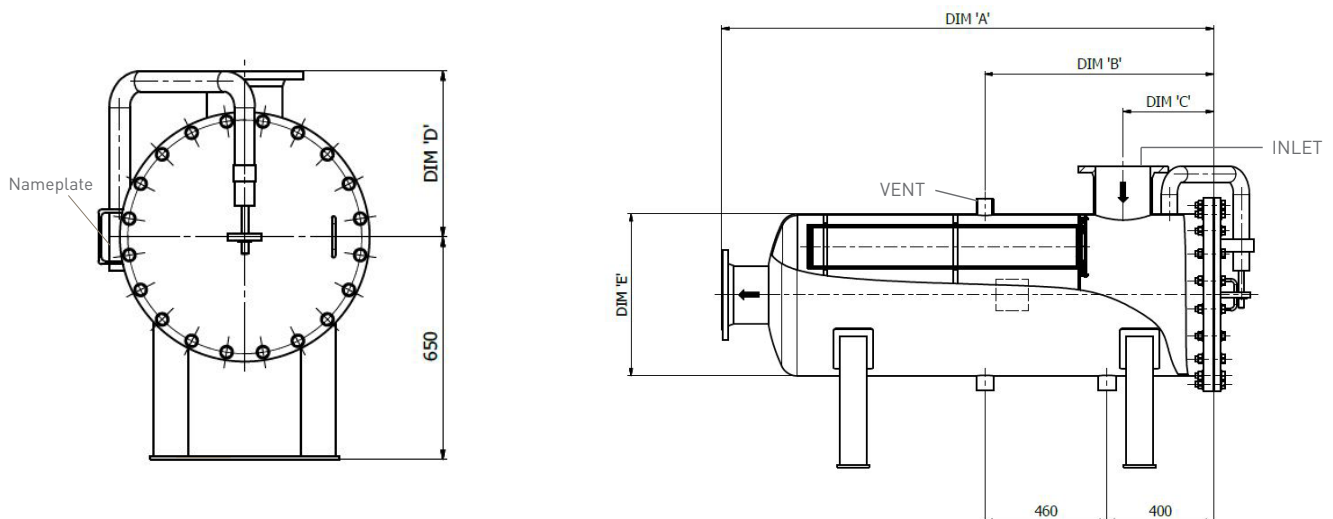



# HPM Filter Housings

Filter housing for Parmax and Parmax-R

## Standard Offerings, BSP Vent and Drain, Industrial Finish

Parker domnick hunter Code	Number of Cartridges	Length (Nominal)	Connection Size	Seal	Orientation
HPMCE012EL-L-E-I-V-B*	1	20" (500 mm)	4" (DN100)	EPDM	Vertical
HPMCE012EL-L-E-I-H-B*	1	20" (500 mm)	4" (DN100)	EPDM	Horizontal
HPMCE014EL-L-E-I-V-B*	1	40" (1000 mm)	4" (DN100)	EPDM	Vertical
HPMCE014EL-L-E-I-H-B*	1	40" (1000 mm)	4" (DN100)	EPDM	Horizontal
HPMCE016EL-L-E-I-V-B*	1	60" (1500 mm)	4" (DN100)	EPDM	Vertical
HPMCE016EL-L-E-I-H-B*	1	60" (1500 mm)	4" (DN100)	EPDM	Horizontal
HPMCE034GL-L-E-I-V-B*	3	40" (1000 mm)	6" (DN150)	EPDM	Vertical
HPMCE036GL-L-E-I-V-B*	3	60" (1500 mm)	6" (DN150)	EPDM	Vertical
HPMCE034GL-L-E-I-H-B*	3	40" (1000 mm)	6" (DN150)	EPDM	Horizontal
HPMCE036GL-L-E-I-H-B*	3	60" (1500 mm)	6" (DN150)	EPDM	Horizontal
HPMCE034HL-L-E-I-V-B*	3	40" (1000 mm)	8" (DN200)	EPDM	Vertical
HPMCE036HL-L-E-I-V-B*	3	60" (1500 mm)	8" (DN200)	EPDM	Vertical
HPMCE034HL-L-E-I-H-B*	3	40" (1000 mm)	8" (DN200)	EPDM	Horizontal
HPMCE036HL-L-E-I-H-B*	3	60" (1500 mm)	8" (DN200)	EPDM	Horizontal
HPMCE054JL-L-E-I-V-B*	5	40" (1000 mm)	10" (DN250)	EPDM	Vertical
HPMCE056JL-L-E-I-V-B*	5	60" (1500 mm)	10" (DN250)	EPDM	Vertical
HPMCE054JL-L-E-I-H-B*	5	40" (1000 mm)	10" (DN250)	EPDM	Horizontal
HPMCE056JL-L-E-I-H-B*	5	60" (1500 mm)	10" (DN250)	EPDM	Horizontal

\* check coding chart for complete code

Note:

NPT vent and drain available upon request.

Inlet/outlet available same and opposite sides.

Vessels are packed in wooden crates for protection during transport.

## Ordering information

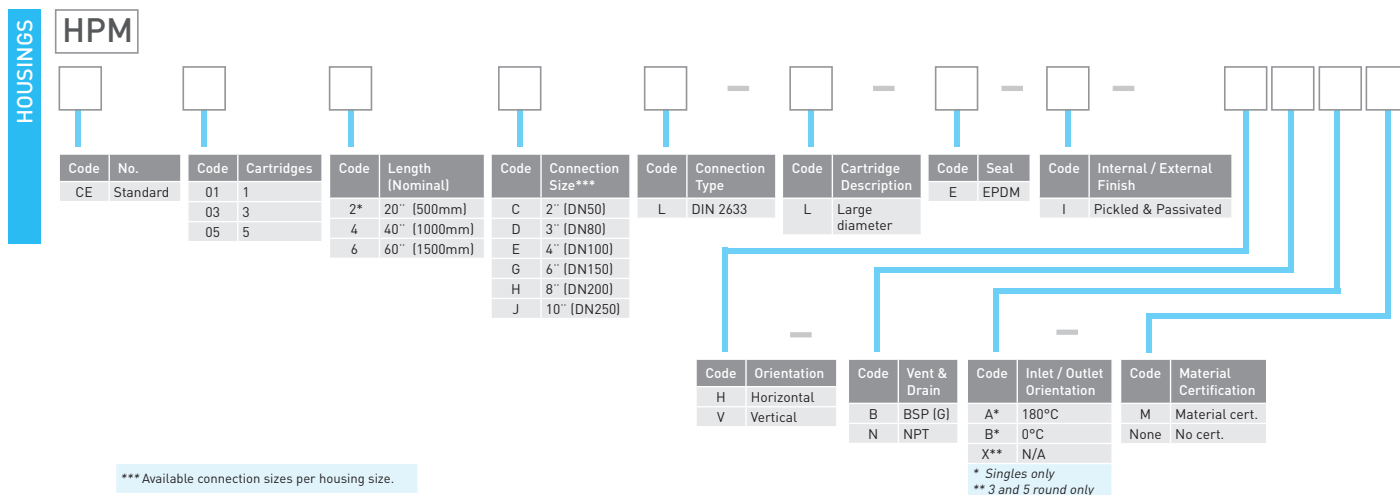

\*\*\* Available connection sizes per housing size.

Number of Cartridges	Code	Connection Code
1	01	C,D,E
3	03	G,M
5	05	J



Parker domnick hunter has a continuous policy of product development and although the Company reserves the right to change specifications, it attempts to keep customers informed of any alterations. This publication is for general information only and customers are requested to contact our Process Filtration Sales Department for detailed information and advice on a products suitability for specific applications. All products are sold subject to the company's standard conditions of sale.

DS\_IP\_18\_REV1